

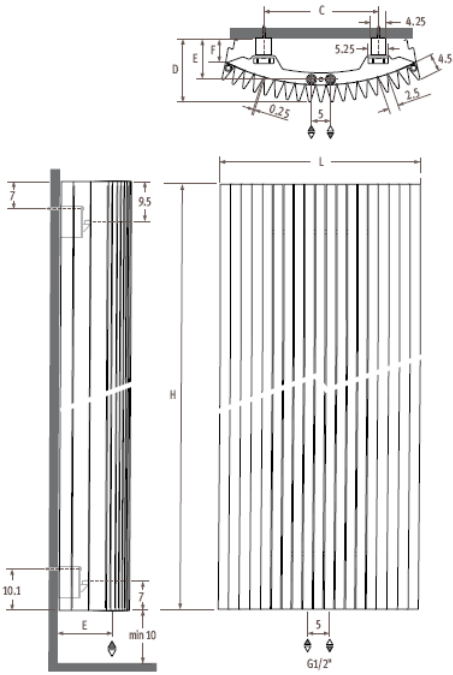

Iguana_Arco Plus

Montagehandleiding - Instructions de montage
Montagehinweis - Mounting instructions



| | | | | | | |
|---|------|------|------|------|------|------|
| L | 29.8 | 41.0 | 51.9 | 62.5 | 73.3 | 83.9 |
| C | 10.0 | 20.0 | 30.0 | 40.0 | 50.0 | 60.0 |
| D | 14.1 | 16.9 | 17.7 | 17.2 | 18.7 | 20.7 |
| E | 8.1 | 10.1 | 11.7 | 11.2 | 12.7 | 14.7 |
| F | 7.6 | 7.9 | 7.3 | 8.0 | 7.5 | 7.4 |

Onderdelen - Parts - Teile

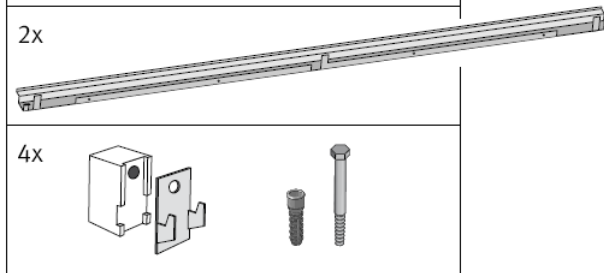

Optie - option

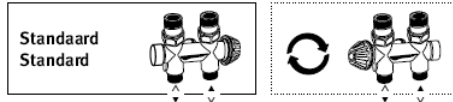
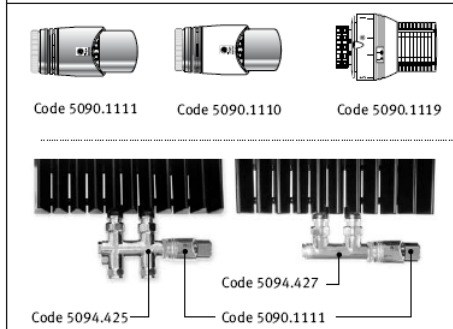

Klemkoppelingen voor ventielen: zie Jaga prijslijst.
Raccords bicônes pour vannes: voir liste des prix Jaga.
Klemmringverschraubungen für Ventile: siehe Jaga Preisliste.
Sleeve couplings for valves: see Jaga price list.

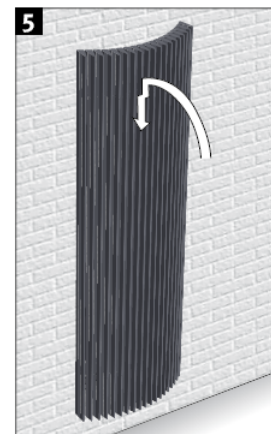
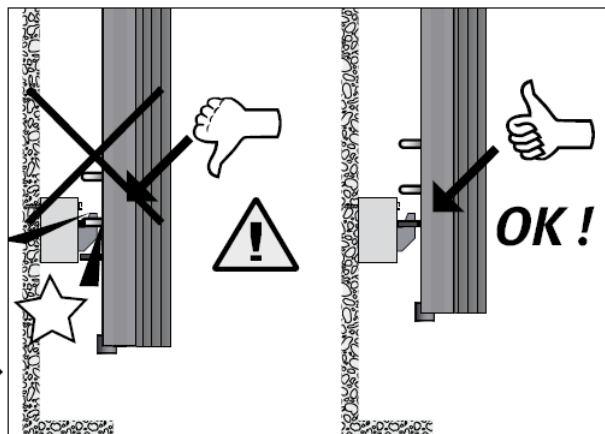
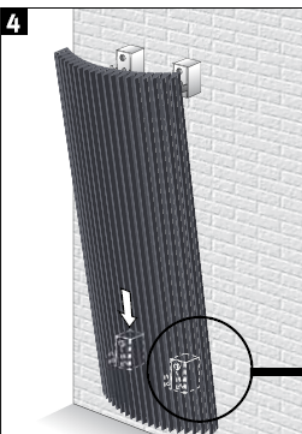
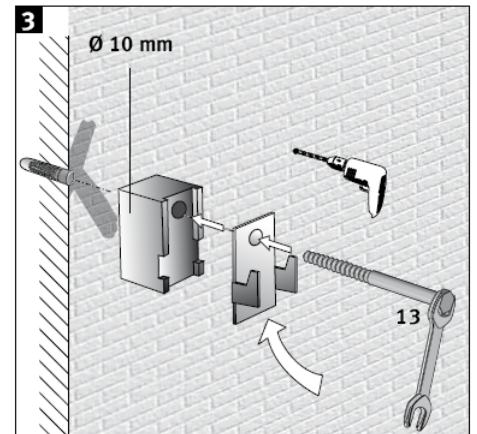
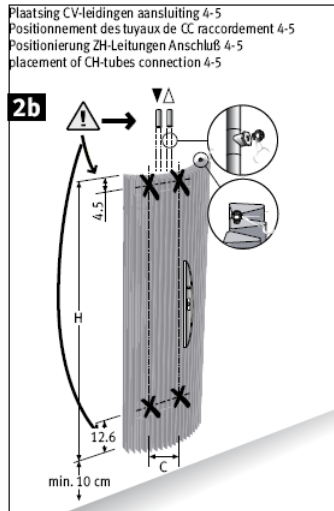
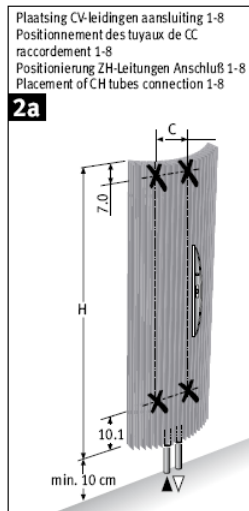
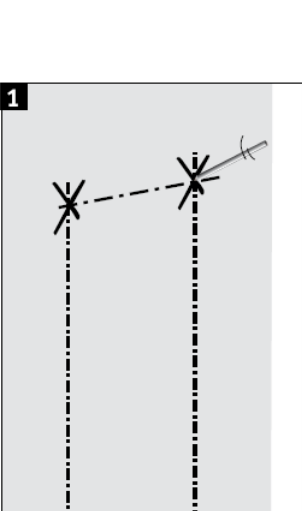

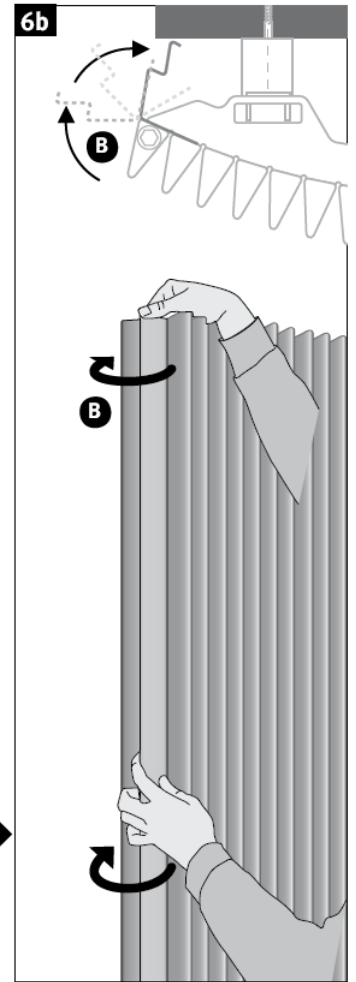
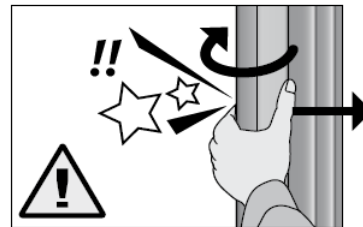
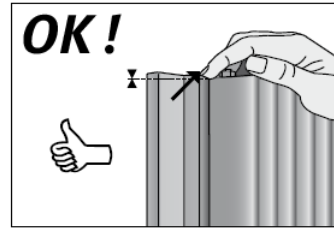
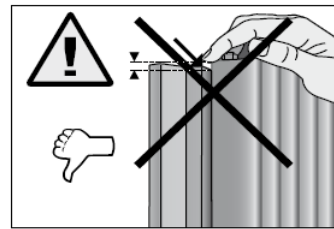
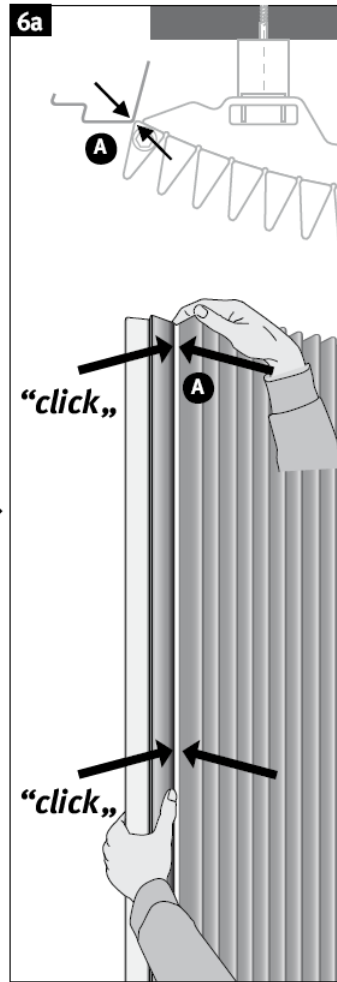
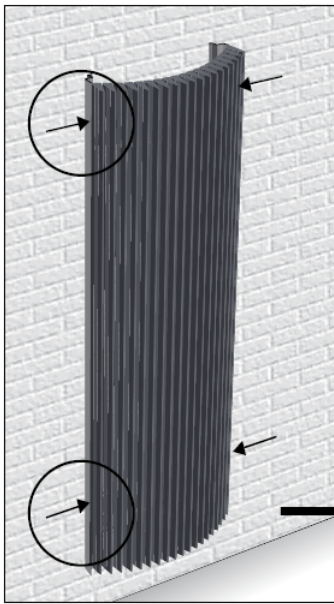

Aansluiting / Connection / Anschluß

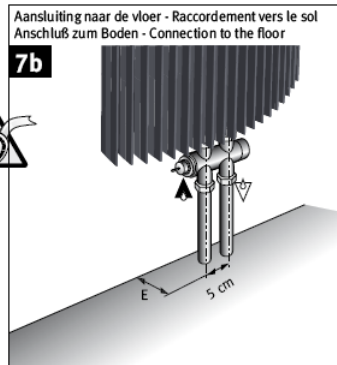
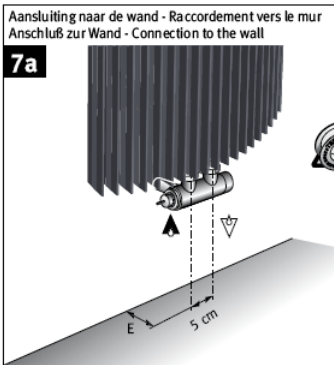

Eenpijp-tweepijpaansluiting / Raccordement monotube-bitube Einrohr-Zweirohranschluf / One pipe-two pipe connection

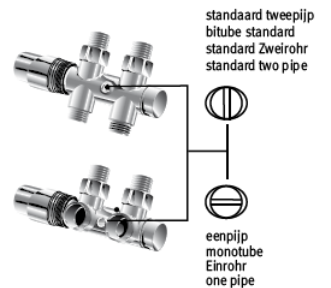
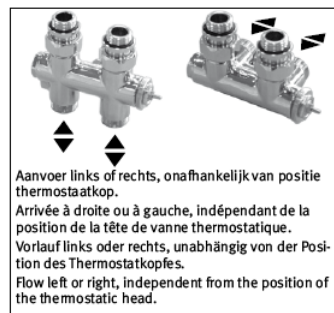

| L | E |
|------|------|
| 30.0 | 8.1 |
| 41.0 | 10.1 |
| 52.0 | 11.7 |
| 63.0 | 11.2 |
| 74.0 | 12.7 |
| 85.0 | 14.7 |